

RAJWADA  
*Rosewood*



ZRICKS™

[www.Zricks.com](http://www.Zricks.com)

## Rajwada Rosewood: A Resort to Serenity

Calm and serene are two words that will describe your home at Rajwada Rosewood. Imagine yourself waking to the chirping of birds and breathing fresh morning air with a steaming cup of coffee. Feels awesome, isn't it?

This can now be a reality with Rajwada Rosewood. Having a serene place within Kolkata seems quite impossible right? But we are making it possible for you, a quiet abode in Kolkata but away from its din and bustle.

Rajwada Rosewood can be a perfect place to reside for busy city dwellers as it will give you a tranquil place to begin and end your hectic days. It is located in the quietness of Narendrapur opposite Chintamani Kur Bird Sanctuary. Its proximity to E.M. bypass and N.S.C Bose Road makes it an easy place to commute from. The nearest landmark is Narendrapur Ramkrishna Mission.

The residency will be covering an area of 52 katha. There will be a total of 86 apartments in a total of 4 blocks. The minimum size of 2bhk is 885 sqft to 1075sqft and that of 3bhk is 1125sqft to 1340 sqft.

Its approximate distance is 4 km from Sahid Khudiram Metro Station, 3km from Bagbazar Narendrapur, 200 meters from Chintamani Birdsanctary, 2 km from Ramkrishna Mission, 2 km from proposed Devi sathi Hospital, and 10 km from Ruby More.

Calm and serene are two words that don't describe your home at Rajwadi Residences. Imagine yourself walking to the chirping of birds and breathing fresh morning air with a steaming cup of coffee. Feels awesome, don't it? This can now be a reality with Rajwadi Residences. Having a serene place within Kolkata seems quite impossible right? But we are making it possible for you - a quiet abode in Kolkata but away from its din and bustle.





APARTMENT NO.	AREA
A	1235
B	929
C	1225
D	1010

BLOCK - 1



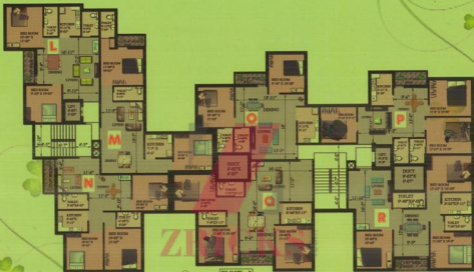

BLOCK - 3

075	000
1000	000
1120	000
1200	000
1300	000
1400	000
1500	000
1600	000
1700	000
1800	000

1	988	255
2	988	255
3	1028	255
4	1028	255



# Rajwada Rosewood



Layout Plan





CCTV Camera



Indoor Games

**Amenities:**

- Swimming Pool
- Children Park
- A/C Community Hall
- Indoor Games
- Gymnasium
- Intercom
- Water Filtration Plant
- CCTV Camera
- Power Back Up etc.



Children Park



24x7 Hr Power Backup

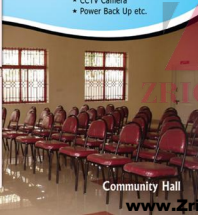

Community Hall



Gymnasium

**Amenities :**

[www.Zricks.com](http://www.Zricks.com)

## Rajwada Rosewood - Specifications

### Structure:

RCC with bricks

### Walls:

Internal: Plaster of Paris finish

External: Finishing with Weather coat paint & graceful elevation

### Flooring:

Entire flat with Vitrified Tiles flooring

Stairs and lobby floor with Marble

Car parking area flooring with Wonder crete

### Electricals:

Concealed ISI copper wiring with Anchor switches

Adequate light and power points

T.V/ Telephone points at Living area

AC point in Master Bedroom

### Kitchen:

Cooking Platform with Granite

Stainless steel sink

Glazed tiles up to 2ft above cooking platform

### Toilets:

Glazed tiles up to a height of 6ft

CP bath fittings of parryware/marc, sanitary fittings of parryware make

Gyser point in one toilet

### Doors:

Main door panel teakwood.

Others - Flush doors

PVC doors at Toilet

Windows

Aluminium Sliding windows with glass panes

### Water supply:

Deep tubewell with water filtration plant

Overhead tank for sufficient storage and supply

### Lift:

Automatic 5 Passenger lift of Adams or equivalent make

### Roof:

Common roof with special treatment

### Loft:

One Loft in each flat

Rajwada Group  
Windsor Greens Appt.  
26, Mahamaya Mandir Road  
Mahamayatala, Kolkata - 700084

Ph: +91 9883322111

Ph: +91 9051127788

Web: [www.rajwadagroup.in](http://www.rajwadagroup.in)

Email: [rajwadagroup@gmail.com](mailto:rajwadagroup@gmail.com)



**RAJWADA**  
G R O U P  
**ZRICKS** ESTD 2002



[www.Zricks.com](http://www.Zricks.com)